

## concealed trap type 300 PC CR, DN 40

Part number: 130297  
 GTIN: 4001636130297  
 Rebate group: 1

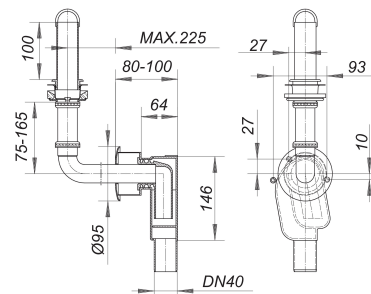

### Description:

concealed trap type 300 PC CR, DN 40  
 conforming to DIN 19541  
 for hospital wash basins (e.g. "Paracelus")

specification:

- space saving built-in trap body
- height adjustable inlet
- escutcheon
- waste
- c.p. standpipe
- removable trap insert

material:

trap in polypropylene  
 inlet c.p. brass, escutcheon stainless steel

### Spare parts:

143020 trap insert for 300, 310

170156 stand pipe, ABS chromed, 100 mm