

floor drain type 46 SE, inlet DN 40, DN 50, 100 x 100 mm

Product No. 460127  
EAN: 4001636460127  
Discount group: 3

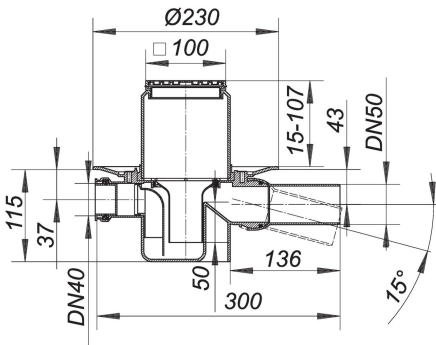

conforming to DIN EN 1253  
outlet DN 50 horizontal, with ball-joint, adjustable 0 – 15 degrees

- specification:
- side inlet DN 40
  - height adjustable grating type E 10
  - removable trap insert, 50 mm water seal
  - temporary blanking plate

material:  
polypropylene  
frame ABS, 100 x 100 mm, grate 304 stainless steel, load class K 3 (300 kg)

The outlet connector can be supplied in ABS to suit British Standard sizes and PE-HD conforming to DIN EN 1519. Please enquire.

Flow rate tested to DIN EN 1253  
(with 20 mm water over grate)

	Norm	DALLMER
DN 50	0.8 l/s	0.81 l/s

Product No.	Description	Dimensions
460059	Floor drain body type 46 S, inlet DN 40, DN 50	DN 50
495204	frame EN 10, 100 x 100 mm	100 x 100 mm
501011	grate E 90, 90 x 90 mm	90 x 90 mm

## 10. calendar\_month\_january 2020

---

495051	Trap insert for floor drain body type 46
--------	--

---

Product No.	Description	Dimensions
495020	Back flow seal S 10, d: 110 mm	d: 110 mm
839503	clamp ring S 10	
831569	raising piece type 85	
832566	raising piece type 85 DallBit	
495075	Two-way seal CeraDrain type S 10	
790323	waterproofing collar S 10, EPDM, d: 420 mm	d: 420 mm
790316	waterproofing collar S 10, flexible PVC, d: 420 mm	d: 420 mm