

floor drain type 32 ERP 12, DN 50, d: 115 mm

Product No. 420329  
EAN: 4001636420329  
Discount group: 3

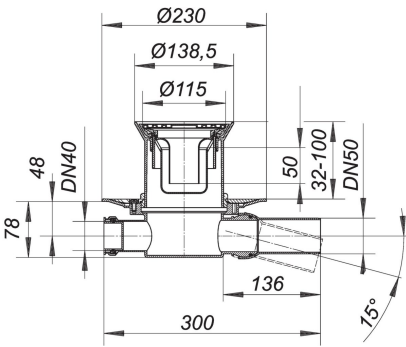

conforming to DIN EN 1253  
with clamp ring for flexible flooring, 1 – 4 mm  
outlet DN 50 horizontal, with ball-joint, adjustable 0 – 15 degrees

- specification:
- side inlet DN 40
  - height adjustable grating ERP 12
  - removable trap insert, 50 mm water seal
  - temporary blanking plate
  - seal CeraDrain S 10

material:  
polypropylene  
frame ABS, grate 304 stainless steel, d: 115 mm, load class K 3 (300 kg)

The outlet connector can be supplied in ABS to suit British Standard sizes and PE-HD conforming to DIN EN 1519. Please enquire.

Flow rate tested to DIN EN 1253  
(with 20 mm water over grate)

	Norm	DALLMER
DN 50	0.8 l/s	0.8 l/s

Product No.	Description	Dimensions
501264	grate VER, d: 115 mm	d: 115 mm

10. calendar\_month\_january 2020

**DALLMER**

---

160966	trap insert ORIO built 2004 - May 2010
495075	Two-way seal CeraDrain type S 10